

- Improved design to meet the measurement needs of various conditions.
- The sensor is rugged and shock-resistant.
- No electrical signal output changes after theoretical electrical travel, making installation easier.
- The new slot design is an ideal alternative to traditional bracket-mounted systems.
- Widely used in plastic molding machines.



**CHARACTERISTIC**

- ◆ Long service life, up to  $50 \times 10^6$  times.
- ◆ Excellent linearity  $\pm 0.07\%$ .
- ◆ Higher resolution 0.01mm.
- ◆ High running speed  $< 10\text{m/sec}$ .
- ◆ DIN43650 Standard plug and socket.
- ◆ **Protection level IP65.**

**SPECIFICATION**

**Electrical Parameter**

- ◆ R tolerance:  $\pm 10\%$
- ◆ Repeatability precise: 0.01mm
- ◆ Cursor current :  $\leq 1\mu\text{A}$
- ◆ Max cursor current: 10mA
- ◆ Power supply: 42V
- ◆ Coefficient Volts to Temp: 5ppm/K
- ◆ Insulation R:  $\geq 10\text{M}\Omega$   
(500Vdc, 1bar, 2s)
- ◆ Insulation strength:  $\leq 100\mu\text{A}$   
(50Hz, 1bar, 2s, 500Vdc)

**Operation force**

- ◆ Vertical installation:  $\leq 0.4\text{N}$
- ◆ Horizontal installation :  $\leq 1.1\text{N}$

**Environment Parameter**

- ◆ Temperature range:  $-40 \sim 100^\circ\text{C}$
- ◆ Life time:  $> 50 \times 10^6$
- ◆ Shock: 50g 6ms
- ◆ Working speed: 10m/s最大
- ◆ Protection class: IP50

**DIMENSION**

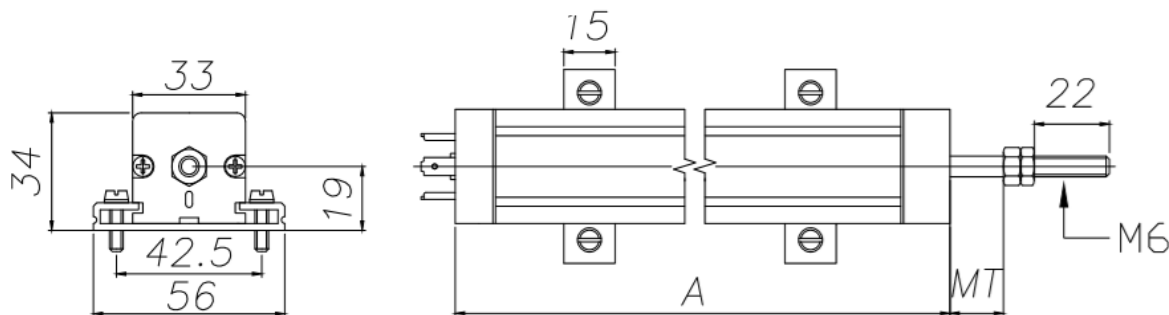

## WIRING CONNECTION

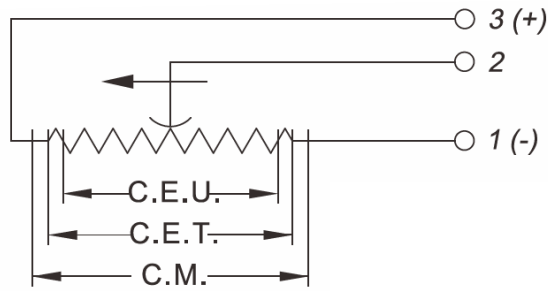

## ORDER INFORMATION CTC-□

Model	Electrical Parameter				Mechanical Parameter	
	Nominal stroke (mm)	Electric stroke (mm)	Standard R (KΩ)	Independent Linearity(%)	Shell Length(A)	Mechanical stroke(M)
75	75	76	5	0.15	139	83
100	100	102	5	0.15	164	109
150	150	152	5	0.1	215	160
175	175	177	5	0.1	240	185
200	200	203	5	0.08	266	210
225	225	228	5	0.08	291	236
250	250	253	5	0.05	317	261
300	300	304	5	0.05	368	312
350	350	356	5	0.05	418	359.5
375	375	378	5	0.05	441	384.5
400	400	406	5	0.05	469	410
450	450	457	5	0.05	519	469
500	500	508	5	0.05	570	515
550	550	559	10	0.05	621	566
600	600	610	10	0.05	671	617
650	650	661	10	0.05	712	667
700	700	712	10	0.05	772	718
750	750	762	10	0.04	822	769
800	800	813	10	0.04	873	820
850	850	855.5	10	0.04	923	871
900	900	906	10	0.04	974	922
950	950	956	10	0.04	1024	922
1000	1000	1006	10	0.04	1075	1022
1250	1250	1259	20	0.04	1323	1266

Standard accessories: Hermans connectorx1 / Seal x1 / Fish eye connector or Universal joint x1  
Aluminum tripod x2 / (M5) Screwsx4