

- Anodized aluminum case
- Rod material: stainless steel
- Adjustable fixed holder; easily installation
- Protection: IP55
- Suitable for most kinds of machines, such like: injection molding machines, die casting machines, rubber machines, footwear machines, EVA injection machines, bottle blowing machines, woodworker machines, hydraulic machines and so on.



**SPECIFICATION**

- ◆ Independent Linear:  $\pm 0.1\%$  (75~175mm) ;  $\pm 0.05\%$  (200~750mm)
- ◆ Repeatability Accuracy: 0.01mm
- ◆ Power Supply Current:  $\leq 1\text{mA}$
- ◆ Storage Temp.:  $-60^{\circ}\text{C} \sim 150^{\circ}\text{C}$
- ◆ Max Speed: 10 m/s

**ORDER INFORMATION**

**DPC-** Code1 - Code2

Code1	Joint type	Code2	Measuring Range(mm)
1	Fish Eye		75, 100, 110, 125, 130, 150,
2	Universal		175, 200, 225, 250, 275, 300,
			325, 350, 360, 375, 400, 425,
			450, 475, 500, 550, 600, 650,
			700, 750

**JOINT DIMENSION**

1: Fish eye

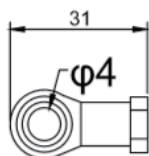

2: Universal

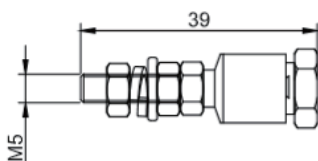

**DIMENSION**

Feature	Model	075	100	110	125	130	150	175	200	225	250	275	300	325	350	360	375	400	425	450	475	500	550	600	650	700	750		
Measuring Range (A.E.) mm		75	100	110	125	130	150	175	200	225	250	275	300	325	350	360	375	400	425	450	475	500	550	600	650	700	750		
Resistance (T.E.) $\pm 20\%$ K $\Omega$		5 K $\Omega$											10 K $\Omega$																
Mechanical Travel (M.T.) mm		A.E. + 7mm																											
Housing Length (A) mm		A.E. + 169.5mm																											

