

- Small size, easy to install.
- Protection level: IP68.
- Pressure and corrosion resistance.
- Long transmission distance and strong anti-interference.
- Widely used in microclimate, facility agriculture, forestry, environmental monitoring, etc qualitative measurement and research on rainwater.

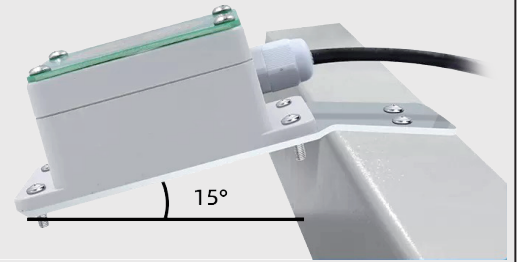

**SPECIFICATION**

- ◆ Power supply: 10~30V DC
- ◆ Maximum power consumption: 0.4W
- ◆ Storage environment: Temp.: -40°C~80°C/ Humi.: 10~90%RH
- ◆ Wire Spec.: Relay/ RS485 (3 Wire)  
Relay+RS485 (4 Wire)
- ◆ Load capacity: AC250V1A/ DC30V1A
- ◆ Protection level: IP68
- ◆ Working environment: -30°C~70°C/ Humi.: 10~90%RH
- ◆ Communication address: 01
- ◆ Response time interval: <1 second

**WIRING CONNECTION**

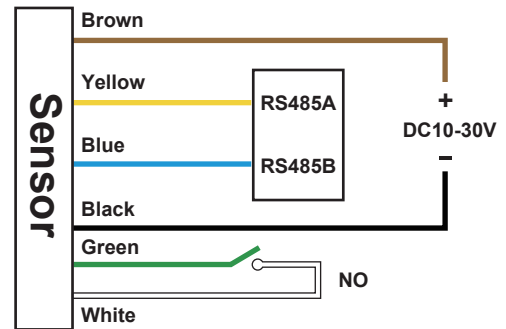

The voltage power input can be 10~30V. When wiring the 485 signal line, note that the A/B lines cannot be connected in reverse, and the addresses between multiple devices on the bus cannot conflict. Switching type devices are equipped with one relay output as standard, and two outgoing lines (green and white) are normally open contacts.

**ORDER INFORMATION**

**RA- Code1 - Code2**

Code1	Output Signal	Code2	Wire Length
R	Relay(NO)	N	0.5M(Standard)
Y	RS-485	O	Option
RY	RS-485/Relay(NO)		



**DIMENSION**

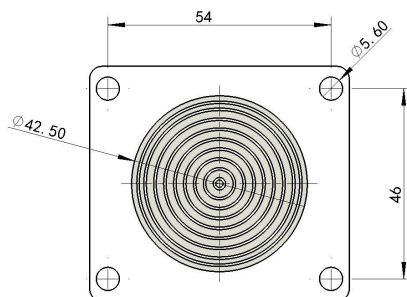
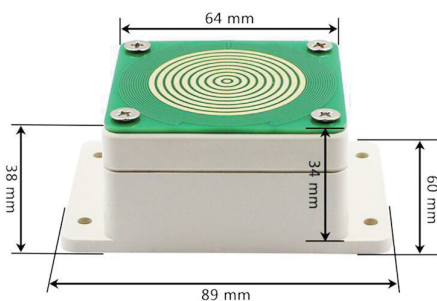

**INSTALLATION**

